



### Click & clean LPJET14 Main station with integrated satellite.

Reference: 100.132

The Click & Clean LPJET series is designed especially for cleaning in high care areas which require a pressure increase and multiple hours of cleaning a day. These units are ideal for bakeries, butchers, super markets and high care food and beverage production areas.

With a single lever the operator can change between the different medias. Only compressed air, water and electric power are to be connected to the unit.

**Functions:**

- Foam cleaning
- Foam disinfection
- Clear water rinse

Click & clean LPJET units are standard equipped with:

- Stainless steel Grundfos booster pump AISI316 , with Bleu Flux "best efficiency " label and flow manager for automatic on/off switch.
- Stainless steel Maintenance free selector valve for water, chemicals and air.
- 2 separated chemical injectors with adjustable dosing ratio (0.15-15%) who makes it impossible to mix-up chemicals.
- Air regulator.
- Air manometer.
- Lockable stainless steel cabinet, with sloped top cover for optimal hygiene.
- Dry running protection.
- 1 x Stainless steel check valve on water supply.
- 2 x stainless steel check valves with extreme chemical resistant Kalrez seals on chemical suction.
- 1 x stainless steel check valve for air supply protection.
- 1 x Check valve with detector when first check valve is failing.
- 1 x bleu suction kit with filter and PVC pipe for foam cleaning chemical.
- 1 x yellow suction kit with filter and PVC pipe for disinfection chemical.
- Set Of dosing tips.
- Exit with water boosted pressure to supply other Click & clean satellites.

Mobile version is extra equipped with:

Ref. 100.132XM

- Click & clean main station with integrated satellite. See here above.
- Stainless steel heavy duty trolley
- 2 x big wheels on the back
- 2 x swivel wheels with brake in the front.
- Container holder for 2 x 25 liter cans.
- Stainless steel automatic spring driven hose reel.
- 20 meter 5 layer hose with textile reinforcements, Foodflex hose, FDA approved. Max. 50bar /70°C.
- Stainless steel isolated ball valve with integrated "3 in 1" triple click nozzle.

Wall mount version.



Mounting example.  
Hose reel and accessories not included.

Mobile version





Technical data Click & clean LPJET14

Water inlet connection:	1" BSP
Required inlet supply pressure:	2 - 6 bar
Required minimal inlet flow:	70 l/min.
Max. water temperature:	70°C
Max. outgoing pressure:	18 bar
Air inlet connection:	1/4" BSP
Required air supply pressure:	1 - 6 bar
Required air flow:	200 Lpm.
Max no of users simultaneously:	2
Chemical injectors (100% separated)	2
Chemical dosing ratio:	0.15 - 15%
Exit to hose reel:	1/2" BSP
Exit to second satellite:	1/2" BSP
Voltage (50Hz)	3 x 400V
Power:	3.2 kW
Cabinet dimensions (WxHxD):	600 x 600 x 250 mm

Connection and use LPJET14 Lain station with second Click & clean Decentral satellite.

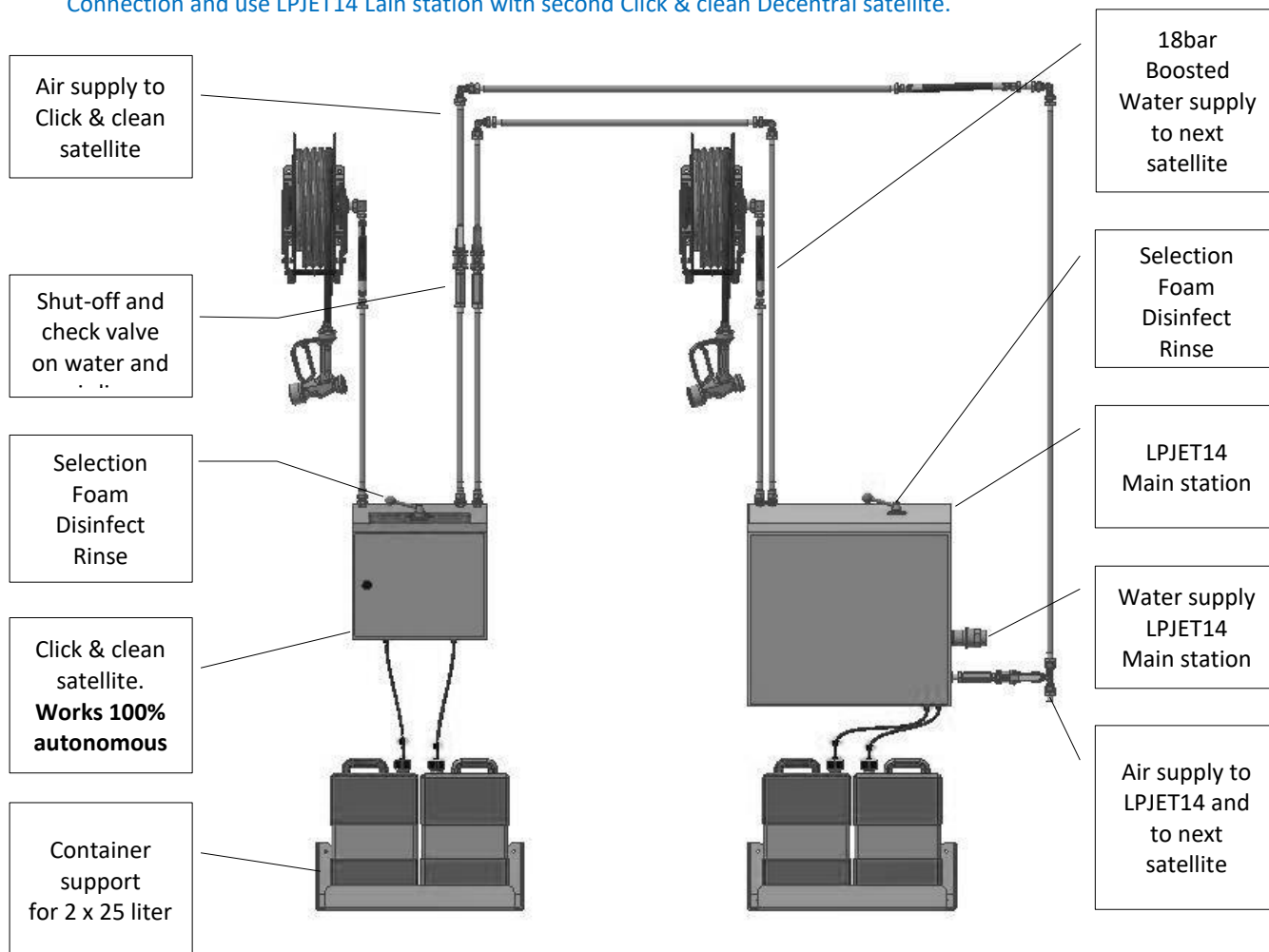



Most common associated products:

<p>Ref.100.201 Click &amp; clean FFR Decentral satellite. Ultra-hygienic, robust and reliable cleaning satellite.</p> <p>Functions:      Foam cleaning                       Foam Disinfection                       Clear water rinse</p> <p>Must be connected to pré-boosted water system like LPJET14 or Rhinojet main stations.</p>																	
<p>Stainless steel automatic spring loaded hose reels with optional wall swivel. Let the hose reel turn 180° on the wall. Standard version 200bar / 90°C. Optional in 400 or 600 bar version.</p> <p>Available lengths for Click &amp; clean LPJET9</p> <table border="1" data-bbox="151 1003 1023 1173"> <thead> <tr> <th colspan="2">Available lengths for Click &amp; clean LPJET9</th> <th>Wall swivel</th> </tr> </thead> <tbody> <tr> <td>Ref. 260.AV 1000</td> <td>15 meter ½" hose.</td> <td>Ref. 260.ST15</td> </tr> <tr> <td>Ref. 260.AV 1100</td> <td>20 meter ½" hose.</td> <td>Ref. 260.ST20</td> </tr> <tr> <td>Ref. 260.AV 3400</td> <td>25 meter ½" hose.</td> <td>Ref. 260.ST34</td> </tr> <tr> <td>Ref. 260.AV 3500</td> <td>35 meter ½" hose.</td> <td>Ref. 260.ST30</td> </tr> </tbody> </table> <p>Hoses are not included.</p>	Available lengths for Click & clean LPJET9		Wall swivel	Ref. 260.AV 1000	15 meter ½" hose.	Ref. 260.ST15	Ref. 260.AV 1100	20 meter ½" hose.	Ref. 260.ST20	Ref. 260.AV 3400	25 meter ½" hose.	Ref. 260.ST34	Ref. 260.AV 3500	35 meter ½" hose.	Ref. 260.ST30		
Available lengths for Click & clean LPJET9		Wall swivel															
Ref. 260.AV 1000	15 meter ½" hose.	Ref. 260.ST15															
Ref. 260.AV 1100	20 meter ½" hose.	Ref. 260.ST20															
Ref. 260.AV 3400	25 meter ½" hose.	Ref. 260.ST34															
Ref. 260.AV 3500	35 meter ½" hose.	Ref. 260.ST30															
<p>Foodflex wash down hoses. 5 Layer hose with textile reinforcement. FDA Approved. Max. 50Bar / 70°C. Hoses are standard equipped with stainless steel ½" MF adapters and ferrules.</p> <table border="1" data-bbox="151 1368 1023 1538"> <tbody> <tr> <td>Ref.30350X1,5</td> <td>1,5 meter(connection between LPJET9 and hose reel)</td> </tr> <tr> <td>Ref. 30350X15</td> <td>15 meter length.</td> </tr> <tr> <td>Ref. 30350X20</td> <td>20 meter length.</td> </tr> <tr> <td>Ref. 30350X25</td> <td>25 meter length.</td> </tr> <tr> <td>Ref. 30350X35</td> <td>35 meter length.</td> </tr> </tbody> </table>	Ref.30350X1,5	1,5 meter(connection between LPJET9 and hose reel)	Ref. 30350X15	15 meter length.	Ref. 30350X20	20 meter length.	Ref. 30350X25	25 meter length.	Ref. 30350X35	35 meter length.							
Ref.30350X1,5	1,5 meter(connection between LPJET9 and hose reel)																
Ref. 30350X15	15 meter length.																
Ref. 30350X20	20 meter length.																
Ref. 30350X25	25 meter length.																
Ref. 30350X35	35 meter length.																
<p>Ref. 140.113 Isolated stainless steel ball valve with integrated "3in1" triple click nozzle. This system prevents nozzles from being lost if they have to be changed when rinsing, foaming or disinfecting. Here no use is made of quick couplings where O rings have to be replaced frequently. With this system nozzles are fixed on the valve and cannot be removed. Insulated against heat and shock resistant.</p>																	
<p>Ref. 270.110 Stainless steel heavy duty wall support for 2 x 25liter canisters.</p>																	



## Technical information

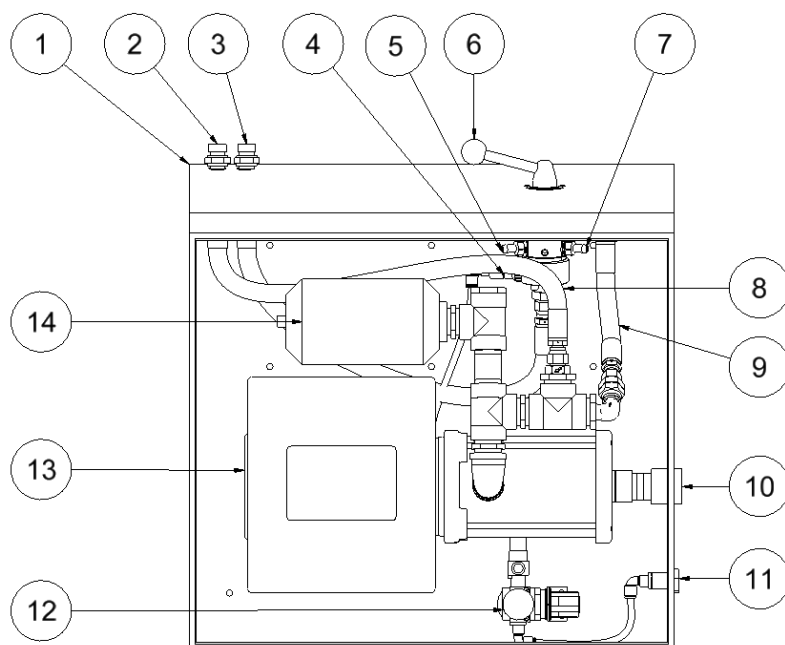

### Part description LPJET14

1	Stainless steel cabinet 600x600x250mm.
2	Adapter G1/2" M BSP to supply boosted water to next satellites.
3	Adapter G1/2" M BSP to hose reel.
4	Air inlet with check valve on Switch box.
5	Chemical (1) suction inlet with integrated check valve.
6	Position Switch handle (Foam, Rinse disinfect).
7	Chemical (2) suction inlet with integrated check valve.
8	Supply hose boosted water to exit adapter.
9	Supply hose boosted water to switch box.
10	Water inlet supply G1" F BSP.
11	Air inlet supply G1/4" F BSP.
12	Air regulator kit (dry/wet foam) with check valve and pressure release.
13	Stainless steel booster pump with frequency controller.
14	Accumulator